

## GAS LEAKAGE ALARM USER'S MANUAL

Model: EL-G02

### SKETCH MAP

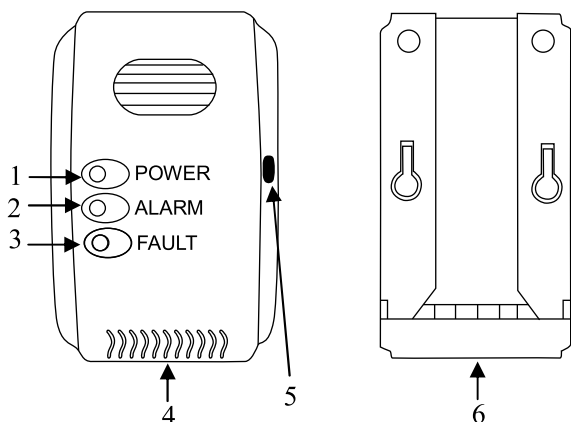

- 1--- Green indicator (for power)
- 2--- Red light (alarm indication)
- 3--- Failure indication light for sensor
- 4---Ventilation slots
- 5---Test button
- 6---Connectors: P1、OUT3、OUT2、OUT1、V1、V2

### FEATURES

Superior gas sensor with Japan technology is adopted for this product, suitable for household.

The ignitable leakage gases can be detected by the method of light/sound alarm and driving the valve to remove the danger.

- Power Source :220V AC

- Sensitivity : 10%LEL
- Power Consumption :  $\leq 1.7W$
- Operating Temperature :  $-10^{\circ}C \sim 50^{\circ}C$
- Ambient Humidity : Less than 95% RH
- Horn Level :85 Decibels
- Type Of Gas Sensed :
  - + LPG (Butane, Propane) used in normal and mini gas bottles
  - + Gas from piping system (city gas) and natural gas (Methane)

### APPLICATION

- Mounted on the wall or cabinet, about 30cm above the ground for LPG or about 30cm below the ceiling for coal gas and natural gas use.
- Ventilation hole showed as sketch map should be installed down.
- Connecting signal wire with auto-valve by matching the same colored wires.
- The equipment needs 3--5 minutes for starting up sensor. The green LED on in normal mode.
- When the ignitable gas is detected, the red indicator shall be flashed with "di-di-di" alarm sound until the ignitable gas disappears.
- If the sensor is invalid, the yellow indicator will be flash.

### ATTENTION

- Install firmly to avoid impact and drop;
- Don't let dust and oil block the ventilation slots;
- Don't install product near hot, humid and oiling sources. Don't install it near window or fan, where leakage gas can be quickly disappeared.

- Monthly checking if equipment can work well by pushing a little gas from a cigar lighter near the ventilation slots.

### HOW TO DO WHEN YOU ARE ALARMED

- Inform to the supplier for warranty if there's something wrong with the equipment. Don't repair or dismantle by unprofessional persons.
- Carefully remove all children and not related people from that area.
- Turn off all gas valve and `gas bottle, open all doors and windows.
- Don't use electrical fans, not turning any contactors. Don't let electric sparks appear.
- Waiting till the equipment stop alarm then checking the gas system or phone to gas supplier to verify it.
- If there's an auto-valve, it'll auto-close the gas pipe. After finalizing all errors of gas system, reset the valve by pulling out the red button.

